



THE CHICAGO PLATFORM TENNIS CHARITIES

APTA National Ranking Tournament & President's Cup Qualifier

November 2nd, 3rd & 4th, 2007 (Page 1 - Schedule; Page 2 -Entry)

LOCATION:

Chicago North Shore area clubs, semi-finals and finals at Glen View Club at 100 Golf Road, Golf, IL, Main Number 847-729-6500; Paddle House Number 847-657-0890.

ENTRIES:

Deadline: Saturday, October 27th, 2007. No refunds after this date. **Full APTA membership is required for all national ranking tournaments.** Applications will not be accepted without both players' APTA numbers or without full payment. **To obtain a number call the APTA at (888) 744-9490 or access the web site at www.platformtennis.org.** Official APTA rules will govern play. All matches best of three sets. 12 point tie-breaker in all sets. Guaranteed 3 matches.

NOTES:

Men's Seniors 95+ (and Men's Seniors 110+) will require the combined ages of the players to be equal to or greater than 95 (or 110, respectively) as of January 1, 2008.

There will be a foot fault judge roaming from site to site. The First call is played as a let, any call there after is a loss of point. *Rule 11 - APTA Official Rules of Platform Tennis.* **The judge's call will be final.**

There is a "No Jeans Policy" at all of the Country Clubs, please give attention to this.

AMENITIES:

Women's Open Tournament: Viking Balls, favor, Friday lunch & Saturday night barbeque. [Friday evening: informal gathering at Glen View Club, (not paid for by the tournament)].
Men's Open Tournament: Viking Balls, favor, Saturday lunch & Saturday night barbeque.
Men's Seniors Tournaments: Viking Balls, favor, (95's-Friday lunch), & Saturday night barbeque.

SCHEDULE:

No Women's check-in. Men & Women can Download Draw from the CPTC website (<http://cptc.reveregroup.com>) for starting times and locations for both Men & Women.

Friday, Nov. 2 nd	8:30 am	Women's tournament play
	8:30 am	Men's Seniors 95+ check-in and continental breakfast at Exmoor CC
	9:00 am	Men's Seniors 95+ tournament play at Exmoor CC
	11:30 am - 1:30 pm	Women's lunch at Glen View Club
	12:00 pm	Men's Seniors 95+ lunch at Exmoor CC
	6:00 pm	Women's informal gathering at GVC Paddle Hut
	6:00 pm - 9:00 pm	Men's optional check-in at GVC Paddle Hut
Saturday, Nov. 3 rd	8:00 am & 9:00 am	Men's Open tournament play
	8:30 am - 4:00 pm	Women's backdraw play
	11:00 am	Women's Semifinals at Glen View Club
	2:00 pm	Women's Finals at Glen View Club
	11:30 am - 1:00 pm	Men's lunch at Glen View Club
	12:00 pm	Men's Seniors 110+ tournament play begins at Exmoor CC
	4:30pm	Men's Quarterfinals at Glen View Club
5:00 pm	(cocktails begin at 4pm) Barbeque at Glen View Club Paddle Hut (No Jeans)	
Sunday, Nov. 4 th	8:30 am	Men's Open backdraw play
	10:00 am	Men's Semifinals at Glen View Club
	1:00 pm	Men's Finals at Glen View Club

FOR ADDITIONAL INFORMATION, CONTACT:

<u>110's</u>	<u>Men's Open and Women's Open</u>	<u>Men's Seniors 95's</u>	<u>Men's Seniors</u>
	John Noble (Chair) (H): 847-234-0941 (cell): 847-226-5030		Howard Sipe Cell 847-989-2236

34th ANNUAL CPTC TOURNAMENT November 2nd, 3rd & 4th, 2007

ENTRY FORM (please detach and send separately)

Women's Open	\$110.00	per paddle	x _____	= \$ _____
Men's Open	\$110.00	per paddle	x _____	= \$ _____
Men's Seniors 95+	\$90.00	per paddle	x _____	= \$ _____
Men's Seniors 110+	\$85.00	per paddle	x _____	= \$ _____
Combined Events	\$170.00	per paddle	x _____	= \$ _____
Dinner Guest Saturday	\$40.00	per person	x _____	= \$ _____
Lunch Guests (Fri. or Sat.)	\$20.00	per person	x _____	= \$ _____
 Total				 \$ _____

WILL YOU _____ OR YOUR PARTNER _____ BE ATTENDING THE SATURDAY NIGHT BARBEQUE? (Place a checkmark next to those attending)

WILL THERE BE ADDITIONAL GUESTS ATTENDING THE SATURDAY NIGHT BARBEQUE? HOW MANY? _____ (Please enclose \$40.00 per guest)

There is a "No Jeans Policy" at all of the Country Clubs, please give attention to this.

Proceeds from this year's tournament will go to: Evanston Northwestern Healthcare – Kellogg Cancer Research

Charitable contribution: \$ _____

TOTAL: \$ _____

Make checks payable to: CPTTC Inc.. Additional contributions can be made out directly to: ENH – Kellogg Cancer Research. (ENH & CPTTC are 503(c) organizations)

HOTELS: Renaissance North Shore, Northbrook, 847-498-6500; Red Roof Inn, Northbrook, 847-205-1755; Doubletree Hotel, Skokie, 847-679-7000; Extended Stay America, Skokie, 847-663-9031.

Mail entries and checks to: John Noble, 1819 Hackberry Lane. Lake Forest, IL 60045

Name: _____	Partner: _____
Address: _____	Address: _____
_____	_____
Phone: (H) _____	Phone: (H) _____
(W) _____	(W) _____
(e-mail) _____	(e-mail) _____
Club Affiliation: _____	Club Affiliation: _____
Current APTA #: _____	Current APTA #: _____

Separate checks payable to "APTA" for APTA membership: \$50.00 Annual Membership. If you are a member of Chicago area CPTC league play, your APTA membership fee has been included in your league fee (please make a note in "Current APTA #" section above if you are a "Chicago league player").



Chicago Area Platform Tennis



(Map not to Scale)

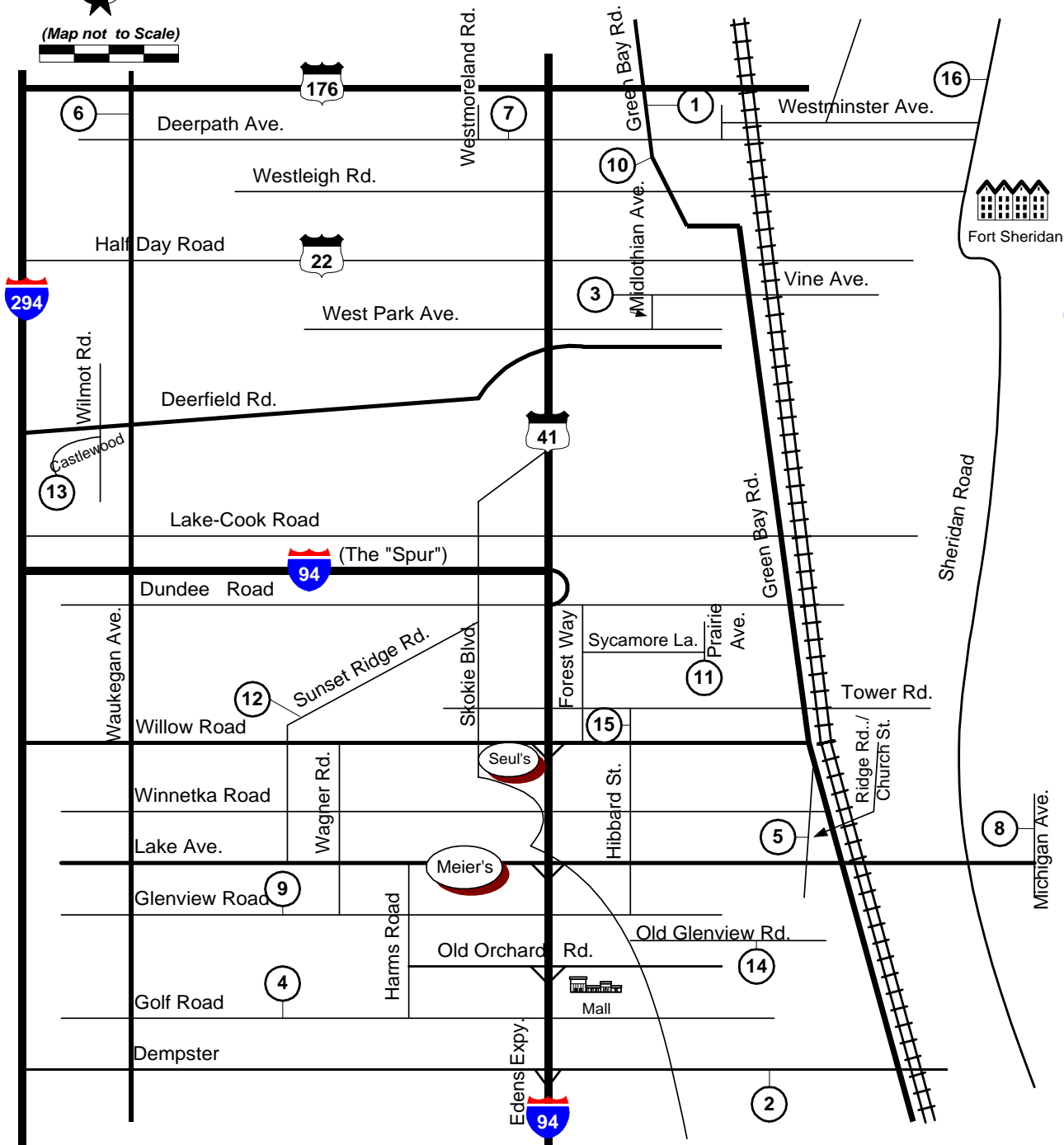

O'Hare Airport

<u>Club</u>	<u>Phone</u>	<u>Club</u>	<u>Phone</u>
1. Bath & Tennis Club	847.234-5001 (s)	9. North Shore CC	847.729-1200 x159 (s)
2. Evanston CC	847.676-1316	10. Onwentsia CC	847.234-1647
3. Exmoor CC	847.432-3600 x157 (s)	11. Skokie CC	847.835-9613
4. Glen View CC	847.657-0890	12. Sunset Ridge CC	847.446-9046
5. Indian Hill CC	847.251-6523	13. Tennaqua	847.945-2100 x8 (s)
6. Knollwood CC	847.234-1628	14. Westmoreland CC	847.853-4714
7. Lake Forest	847.234-5318	15. Winnetka	847.501-2079
8. Michigan Shores	847.251-4100 (s)	16. Winter Club	847.234-0030 (s)

(s) = switchboard, no direct line Note: Meier's: 847.724-0477 Seul's: 847.441-8290